

Robertson County Schools

# **SPRINGFIELD HIGH SCHOOL & CAREER AND TECHNICAL CENTER**

## **STUDENT HANDBOOK**

5240 Hwy 76 East  
Springfield, TN 37172  
615-384-3516  
FAX 615-384-0247 (SHS)  
FAX 615-384-6215 (CTE)



## **2021-2022**

### **Principal**

Mr. Larry Staggs

### **Assistant Principals**

Mrs. Angie Inman  
Dr. Casey Kuhn  
Dr. Chris Tucker

### **Director of Schools**

Dr. Chris Causey

### **Assistant Director of Schools**

Mrs. Melanie Dickerson

# ROBERTSON COUNTY SCHOOLS

## Mission Statement

To ensure each student is prepared to succeed in life.

## Vision Statement

Robertson County Schools will enable all students to reach and exceed high academic standards will empowering them to succeed in a technologically advanced and culturally diverse society.

## CORE BELIEFS

**Purpose:** We believe there is no profession with a greater purpose than ours. We understand our responsibilities are complex. We develop minds and character. We inspire those in our care to think, to question, and to imagine a life better than the present. We recognize there is a ripple effect within our work: well-rounded, educated students lead to improved communities, a stronger nation, and an informed society.

**Trust:** We believe that trust is the foundation from which all other core beliefs develop. Trust is essential if an organization is to thrive and succeed. We recognize trust is multifaceted - it involves competence, character, and contractual obligations. It is developed and earned over time through our words and our actions. We acknowledge that trust generates commitment, fosters teamwork, and promotes progress.

**Communication:** We believe effective communication determines whether we fall short or succeed as an organization. At a basic level, efficient communication provides guidance for our daily work. In voicing our expectations, we must be intentional and consistent. At a deeper level, our communication practices value the ideas and opinions of all involved. These practices are open, honest and purpose driven.

**Collaboration:** We believe collaboration creates a culture of continuous improvement. We know effective collaboration is driven by a common mission. It occurs within a context of trust and respect. Through collaboration, we support innovation, solve problems and provide for high levels of student learning. We recognize our work is too important to attempt in isolation.

**High Expectations:** We believe high expectations result in high performance and are the right of every individual connected to our school community. Equality, appropriate levels of challenge and accountability are necessary in a culture of high expectations. We support this belief through the decisions we make and the resources we provide. We expect success - wasted time and mediocrity are unacceptable.

**Respect:** We believe respect is dependent upon feeling safe, supported, engaged and valued. We know fairness, equality, truth, and civility are precursors to earning one's respect. We recognize and appreciate everyone's voice. We value diversity in individuals' backgrounds, experiences, approaches and ideas.

**Knowledge:** We believe operating without accurate knowledge is educational malpractice. It is our responsibility to continually seek current and relevant knowledge to guide our practices. We believe this is how we reach excellence. It is also our responsibility to transfer the need for knowledge to our students. A life-long learner seeks improvement for self and for the community as a whole. Knowledge sustains our journey.

# **Welcome to Springfield High School!**

## **Mission Statement**

Our mission is to create a safe and challenging environment where students will learn, achieve and demonstrate the knowledge and skills necessary to master the standards set by Robertson County Schools and the Tennessee State Board of Education.

## **Vision Statement**

Our vision is to graduate all students prepared with the knowledge, skills, and competence needed for the next step in their educational process and for the challenges in a diverse, complex society.

Welcome back to Springfield High School. We hope you are excited about another fantastic school year. Make every effort to be a part of the many things we have to offer here at SHS and make your high school experience a memorable one. We are glad to have you here at SHS and look forward to seeing you be successful!

### **Scheduling:**

Most of our classes are 80-85 minutes long and last only one half of the year. We also have a 30-minute RTI/Enrichment time during the school day. Doors open daily at 7:50.

### **Grading:**

Students will receive progress reports every 4.5 weeks in addition to weekly updates in PowerSchool. Students will receive report cards once every 9 weeks. Midterms are given in October and March, and final exams are given in December and May.

### **Food Service Programs:**

ALL students will be served free breakfast and lunch. Breakfast is served starting at 7:50 in various locations depending on the mode of arrival for students.

### **ACT Focus:**

We hope you focus to raise your ACT score and to achieve the college readiness benchmark scores set by the state of Tennessee. We will have awards based on meeting those benchmarks after the state testing day. There is also an awards day called ACT Counts where all students meeting 3 of the 4 benchmarks will be invited to attend the celebration.

## SHS Bell Schedule 21-22

Doors Open	7:50	
Breakfast	Breakfast on the go at 8:10	Students report directly to class after getting breakfast
1 <sup>st</sup> Block	8:25 - 9:45	
2 <sup>nd</sup> Block	9:50 -11:10	
OT	11:15 -11:45	
3 <sup>rd</sup> Block	11:50-1:50	
A Lunch	11:50 - 12:15	CTE Buses Arrive 11:45
B lunch	12:20 -12:45	
C Lunch	12:55 - 1:20	
D Lunch	1:25 - 1:50	
4 <sup>th</sup> Block	1:55 - 3:25	All students dismissed at 3:25

# Arrival to SHS-Traffic Flow

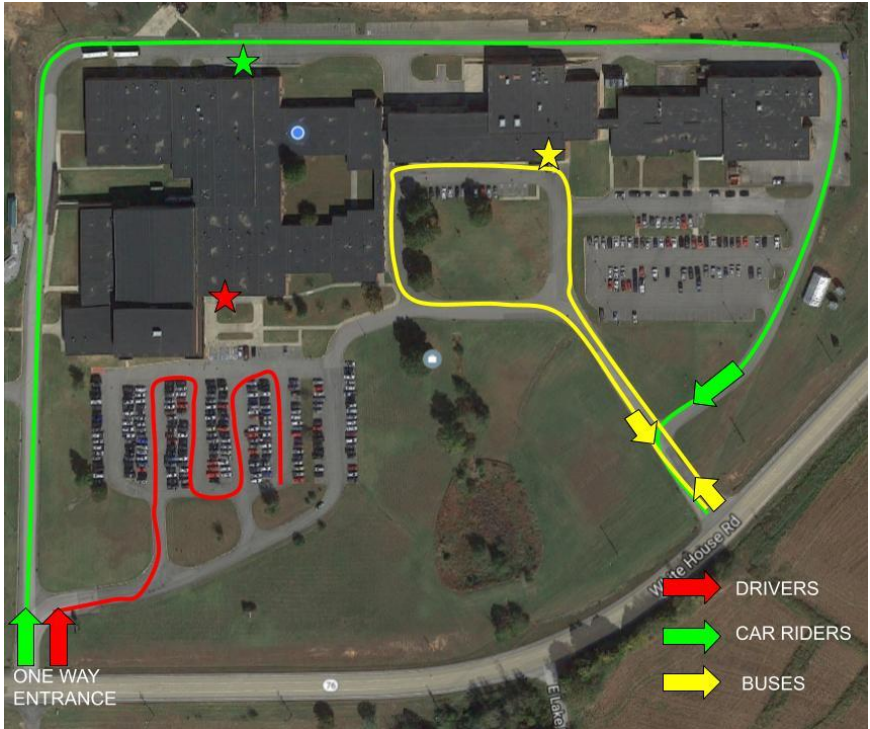

# Dismissal from SHS-Traffic Flow

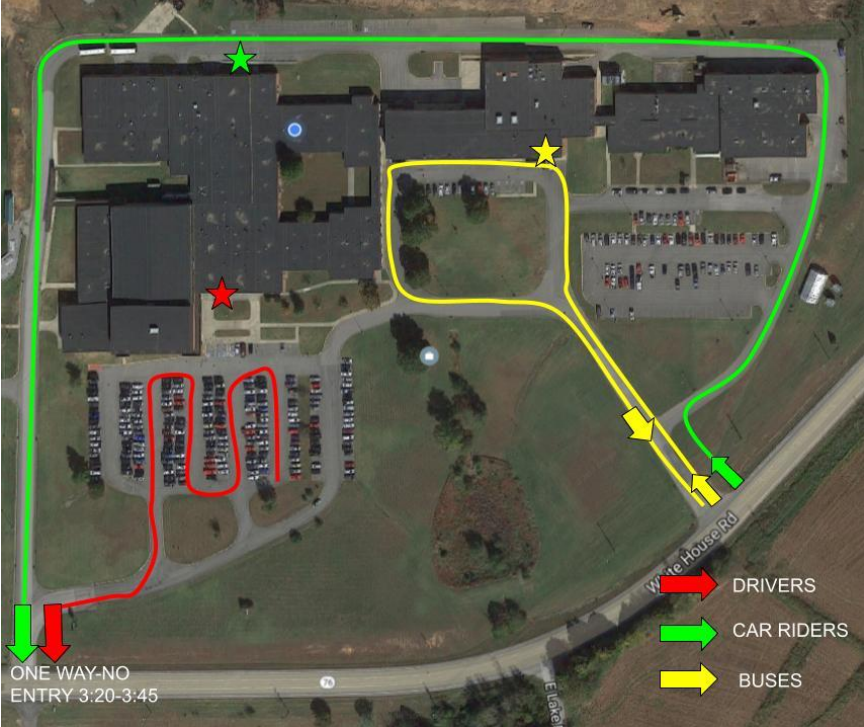

# SHS Teaching Faculty

Ambrose, Savannah	D Hall CHOIR Room
Axley, Elizabeth	E-70
Axley, William	V-80
Bailey, Liz	D-69
Bradley, Bronson	A-03
Bradley, Mary Kate	D-67
Bruce, LouAnn	B-20
Bunch, Tonya	D-68
Burke, Erin	A-07A
Buttram, Jake	GYM
Castiglione, Catherina	V-86
Chism, Laurie	SPED
Cobb, Ann-Marie	SPED
Damer, Nancy June	D-58
DeFrancesca, Zac	B-21
Diaz-Barriga, Herman	A-06B
Dossett, Kenya	C-45
Duncan, Lori	COUNSELING
Dyer, Arielle	A-09
Ellis-Head, Emily	C-55
Ells, Marlaine	B-28
Groves, Vanette	D-60
Hager, Joshua	A-10
Harris, Megan	E-75
Head, Brooke	C-47
Higdon, Rebecca	D-57
Holland, Doug	C-51B
Holmes, Mary	M-14
Holzer, Chris	GYM
Inman, Angie	CTE Admin Office
James, Andrew	A-04
Jones, Jessica	D-62

Kiggans, Julianna	E-78
Koran, Tara	GYM
Kuhn, Donald Casey	A Hall Admin Office
Lamb, Michael	A-05
Lennon, Gary	E-71
Lightfoot, Dale	C-48
Long, Chris	B-18
Martone, James	A-12
Massey, Kenneth	D-66
McIver, Sarah	D-Hall Office
Miksch, Allison	COUNSELING
Minnicks, Amy	E-74
Montgomery, Tanya	B-23
Murrell, Stephanie	V-90
Nation, Rob	C-51A
Neblett, Alexandria	D-61
Neidert, Kasey	B-25
Newberry, Julie	V-83
Overstreet, Tim	A-02
Owsley, Daniel	V-84
Parchman, Abney	E-76
Parrish, Jennifer	E-72
Puentes-Torres, Audrey	B-26
Raines, Cindy	A-07B
Rau, Christopher	GYM
Richards, Danielle	V-87
Rochester, Micah	A-11
Russell, Tiffany	V Hall- Culinary Lab
Salazar, Sandra	B-17
Selph, Kristin	V-86
Smith, Katie	C-56
Stafford, Stacey	A-06A
Staggs, Larry	Main Office Admin



Steele, Elizabeth	M-13
Stinson, Mary	E-73
Storey, Cindy	M-15
Tedrow, Samantha	B-27
Thalman, Brandy	COUNSELING
Thomas, Hannah	D Hall Office
Tidwell, Stephen	B-19
Tinkle, Ashley	V-79
Towry, Robyn	C-43
Tucker, Amy	D-65
Tucker, Chris	B Hall Admin Office
Turpen, AnnMarie	M-16
Tyson, Sherri	D-67
Vaden, Josh	B-22
White, Daniel	V-85
Wiggins, Jonathan	C Hall- Band
Wilkerson, Jennifer	E-77
Wilson, Drew	D-59
Wilson, Dustin	B-29
Wolford, Terese	A-08

# **Clubs and Organizations**

**AFJROTC**-Major Dale Lightfoot, Chief Rob Nation, & Sgt. Doug Holland

**Anime and Manga Club** - Heather Chandler

**Art** - Emily Ellis-Head

**BETA** - Hannah Thomas, Michael Lamb, Alex Neblett, Josh Vaden

**Chem Club** - Elizabeth Axley

**Choir** - Savannah Ambrose

**Culinary Arts**- Tiffany Russell

**FBLA** - Alex Neblett

**FCCLA** - Brooke Head

**FCA** - Michael Lamb

**FFA** - Julie Newberry

**Gaming Club**- Josh Vaden & Alex Neblett

**Gov't, YIG, Mock Trial** - Hannah Thomas, Tim Overstreet, Kristin Selph

**HOSA** - Will Axley

**Junior Civitan** - Emily Ellis-Head

**Key Club** - Kate Bradley

**Math Club** -- Nancy June Damer

**Mindfulness Club** - Chris Long

**National Honor Society** - Hannah Thomas & Alex Neblett

**Pep Club** - Kate Bradley & Julianna Kiggans

**Spanish National Honor Society** - Sandra Salazar

**Spanish Club** - Sandra Salazar

**Recycling Club**-Audrey Puentes

**Renaissance** -Hannah Thomas & Alex Neblett

**Skills USA** - Danielle Richards

**Student Council** -Nancy June Damer, Josh Hagar, Hannah Thomas

**TSA** - Stephanie Murrell

# **Athletics and Head Coaches**

Football - Dustin Wilson  
Girls Soccer - AnnMarie Turpen  
Cross Country - Gary Lennon  
Golf - Andrew James  
Volleyball - Ann-Marie Cobb  
Boys Basketball - Micah Rochester  
Girls Basketball - Tara Koran  
Track - Ann-Marie Cobb  
Baseball - James Martone  
Softball - Daniel Owsley  
Tennis - Curtis Holland  
Boys Soccer - Zac DeFrancesca  
Wrestling - Chris Holzer  
Cheerleading - Abney Parchman  
Band - Jonathan Wiggins

**According to TSSAA by-laws, a student must receive 6 credits during the previous school year to be eligible to participate in varsity sports.**

## **WHO TO SEE FOR HELP:**

<b>If I am sick at school:</b>	Ask your teacher for a pass to the school nurse.
<b>If I missed a day and need it excused, or I need to check out early:</b>	Bring your excuse to the front office before the bell to begin school rings at 8:25. All check out notes need to be given to your 1 <sup>st</sup> block teacher. They must have a parent number on them for verification.
<b>If I am 18 and need to check out without a note from home:</b>	You must speak directly with an administrator for permission.
<b>If I have a question about attendance:</b>	See Ms. Proctor in the front office.
<b>If I need to use the phone:</b>	Ask your teacher to write a note for you to use the phone in the front office or speak with an assistant principal.
<b>If I am struggling in my classes or need help with my homework/assignment:</b>	Speak with your teacher and schedule time for tutoring after school or Homeroom.
<b>If I am not being challenged in my classes, or if I feel my classes are too difficult:</b>	Speak with your teacher and/or your counselor.
<b>If I want to make sure I am on track to graduate, or if I don't know what I want to do after I graduate:</b>	Speak with your school counselor.
<b>If I am having emotional issues:</b>	Speak with your counselor and/or a teacher you trust.
<b>If I feel that I don't fit in, I am being treated unfairly, or I am being picked on/bullied:</b>	Speak with your counselor and/or a teacher you trust.
<b>If I do not have anywhere to live, or if I do not have enough to eat:</b>	Speak with your school counselor and/or a teacher you trust.
<b>If I need to buy a parking pass:</b>	Speak with Ms. Horn/Ms. Proctor in the front office. We will also sell passes for \$10 at Open House.
<b>If I want to buy a yearbook:</b>	Speak with Mrs. Holmes or a member of the yearbook staff. You may also purchase a yearbook online via our school website.
<b>If I want to buy season passes to athletic events:</b>	Talk to Mr. Dustin Wilson for football season passes.
<b>If I am not sure if I am eligible to play sports:</b>	Speak with the athletic directors (Coach Dustin Wilson) or the coach of your sport.
<b>If I want to join a club or extracurricular activity:</b>	We encourage you to participate in several extracurricular activities while in high school. Please talk with the teacher who sponsors an activity that interests you.
<b>If I am having a conflict with a teacher, coach, or administrator:</b>	Anytime you have a conflict with an adult, you should first speak directly to that individual. If you are unable to resolve your differences, the counseling department is trained to help with situations like these. If you are unable to reach a resolution, speak to an assistant principal or the athletic director if it involves a sports issue. If those options do not work, speak with one of the four principals.

# **Springfield High School Policies, Procedures, & Information**

## **Acceptable Use Policy**

Robertson County Schools diligently strive to provide all students with access to technology in the schools. All students and employees shall sign an acceptable use policy if they wish to have access to or use technology equipment in our school system. When using any Robertson County Schools Technology Resources including computers and the Internet, students shall not:

- Send, display, or download offensive messages or pictures
- Duplicate software (disk, CD music or data)
- Use obscene language
- Attempt to bypass system protection
- Harass, insult, embarrass or attack others (Cyber-bullying)
- Use the network or systems for commercial use
- Damage computers, computer systems, computer networks, or other district equipment
- Buy or sell on the Internet
- Download music or software for non-educational purposes or personal use
- Attempt to enter administrative network areas or other network areas not related to specific classroom
- Violate copyright laws
- Use other users' passwords
- Trespass in other users' files, folders or work
- Intentionally waste limited Resources
- Load software not specifically licensed to Robertson County Schools
- Disregard internet safety practices
- Use a third-party Internet provider while on school property (personal hotspot)
- Attach non-approved devices to the school network (personal router)

If a student is part of a 1:1 laptop program, student/parent understand that they are responsible for equipment that is school issued including all accessories. This equipment is treated the same as textbooks issued according to board policy (Student Fees and Fines 6.709, Care of School Property 6.311). An optional protection plan can be purchased. This protection plan covers accidental damage and theft. This plan does not cover negligence.

All data including e-mail communications stored or transmitted on school system computers shall be monitored. Employees/students have no expectation of privacy with regard to such.

Safety instruction - Students will be given appropriate instruction in internet safety, security, appropriate online behavior and cyberbullying awareness. All data including e-mail communications stored or transmitted on school system computers shall be monitored. Employees/Students have no expectation of privacy with regard to such data. I understand that any or all of the following sanctions could be imposed if I violate any of the policies and procedures regarding the use of Robertson County Schools Technology Resources, including the Internet.

Loss of access to Internet and or use of computers or other technology resources  
 Additional disciplinary action to be determined at the school or district level in line with existing practice regarding inappropriate language or behavior  
 Legal action, when applicable

Sanctions listed above may also apply when activity away from school is harmful to or involves other students/staff and/or causes a disruption with regular school business.

The information above is an overview of Board Policy #4.406. You can review the entire board policy at [http://www.rcstn.net/board\\_of\\_education/policies](http://www.rcstn.net/board_of_education/policies) . Board policy will be enforced in all Robertson County Schools.

**ACT Test Dates**

Test Date	Registration Deadline	End of Late Registration
September 11, 2021	August 6	August 20
October 5, 2021	SENIOR ACT DAY	SENIOR ACT DAY
October 23, 2021	September 17	October 1
December 11, 2021	November 5	November 19
February 12, 2022	January 7	January 21
March 1, 2022	JUNIOR ACT DAY	JUNIOR ACT DAY
April 2, 2022	February 25	March 11
June 11, 2022	May 6	May 20
July 16, 2022	June 17	June 24

[www.act.org](http://www.act.org)

## **Absence Information**

- Students must report to the main office at 8:00 if they have missed the previous day or any part of the previous day to obtain a blue note.
- A note from a parent, guardian, or doctor should be given to the office staff, complete with dates, reason for absence(s), signature, and a phone number for verification.
- If a student has missed 3 consecutive days due to illness, a doctor's note will be required.
- Students are allowed three parent notes per semester. All other notes must be from a Doctor, court, or proof of a death in the family. All parent notes must be turned in within three school days of the absence.
- To leave campus after he/she has arrived, a student must give the attendance office a written notice by a parent and the student must sign out in the main office. There will be no phone, fax or email check-outs. All notes must be given to the 1<sup>st</sup> block teacher and will be verified before a student can leave.

## **Absence Procedures**

- A blue (excused absence) note will be issued from the front office staff to the student. The student must present this note to each teacher of the class or classes missed the previous day. The teacher will mark in his/her gradebook whether the absence was unexcused or excused. All absences will be unexcused unless a blue note is obtained.
- Students will need to turn in their absentee note to the teacher of the student's last class of the day, which will be turned into the office and filed in the student's attendance folder.

## **Attendance Regulations**

- All work missed due to an unexcused absence will be rescheduled at the discretion of the teacher. It is the responsibility of each student to initiate the desire to make up the work on the day he or she returns to class. Excused absences include: illness, death in the family, court appearance, medical examinations, religious holidays, college visits if they are pre-approved.
- **Any student with 5 or more unexcused absences will be considered truant and treated accordingly.**
- *Robertson County School Board Policy 6.200:* An accumulation of 8 unexcused early dismissals and/or unexcused early checkouts throughout the entire school year will be considered one day's unexcused absence.

### **Student Responsibility Concerning Attendance**

- It is the student's responsibility to request make-up work from their teachers after returning from an absence.

### **Parent or Guardian Responsibility Concerning Attendance**

- It is the responsibility of the parent or guardian to provide, in writing, a note for any absence, tardy to school, or early dismissal,

in addition to a phone number. In case of emergencies, the parent must sign the student out in the main office.

- Parents, not the school, are ultimately responsible for their child's attendance until the child reaches his or her 18<sup>th</sup> birthday, according to Tennessee Code Annotated (TCA) 55-50-321 and TCA 49-6-3017. Parents may be subject to legal fines and/or imprisonment if charges are filed.

## **Bookkeeping**

- We accept cash and checks for payment at the teacher's discretion.
- If a check is returned from the bank, the parent/guardian will be responsible for the amount of the check plus a \$15.00 returned check fee.

## **Bus Rules**

School buses are extensions of the school and a privilege; misbehavior doesn't stop at the edge of the school grounds. Students are instructed to follow these rules of behavior.

- Students shall remain back from the roadway while awaiting the arrival of the bus.
- Students will refrain from throwing things and playing at a bus stop.
- Students shall enter the bus in an orderly fashion and go directly to a seat.
- Students shall keep their hands, arms and head inside the bus.
- There shall be no shouting, roughhousing, or throwing things on the bus.
- All articles such as athletic equipment, books, musical instruments, and so forth must be kept out of the aisles.
- The emergency door must be used for an emergency only. Students shall not touch safety equipment on the bus.
- There shall be no smoking/vaping at any time on school buses.
- Students who must cross the street at a bus stop shall not do so until they receive a signal from a bus driver.
- All directions given by the bus driver are to be followed.
- Disciplinary issues on the bus will be referred to SHS administration where normal consequences will apply for misbehavior.
- Bus transportation is a privilege and students who do not abide by the rules for riding will be removed from the bus.

## **Cell Phone Policy**

*Robertson County Board Policy 6.312*

Students in grades 6 - 12 may possess personal communication devices and personal electronic devices so long as such devices are turned off and stored in backpacks, purses, or personal carryalls. Such devices include but are not limited to: wearable technology such as eye glasses, rings, or watches that have the capability to record, live stream or interact with wireless technology; cell phones; laptops; tablets; and mp3 players. At no time shall a student operate a cellular device with video or picture taking capabilities in a locker room, classroom, bathroom, or other location where such operation may violate the privacy right of another person. Violation of this policy may result in confiscation of the device and other disciplinary actions. At no time shall



the school be responsible for preventing theft, loss or damage to devices brought onto school property. Students can use personally owned devices in the classroom for education purposes only, and this must be done under the direct supervision of the teacher.

**1st offense**—Confiscation of device; return in 3 school days or a \$10 fine.

**2nd offense**—Confiscation of device; return in 5 school days or \$20 fine.

**3rd offense**—Confiscation of device; return in 10 school days or at end of grading period, whichever is longer, or \$30 fine.

**4th offense**—Confiscation of device; return at end of semester or \$40 fine. Subsequent offenses will be treated under 4th offense guidance and may result in more serious consequences.

## Check-Out Procedure

- Any student leaving campus for any reason after he or she has arrived at school must sign out through the main office.
- Students who require an early check-out should turn in a note to the front office with date, time of check-out, reason, signature of parent or guardian, and phone number for verification upon arrival to school. **If verification cannot be obtained, the student will not be allowed to check out.**
- Students checking out early should report to the main office at the appropriate time and sign out before leaving the building. Students must leave school grounds after signing out.
- Any student leaving campus without signing out will be considered skipping school.
- Students 18 years of age or older must have permission from an administrator to sign themselves out of school each time.

## Computer Lab Policies

- Student using computer labs with their classroom teachers must adhere to all Robertson County School Board policies regarding computer lab and technology usage. The following are general rules and policies that must be followed.
- No food and drink will be allowed at any time in the computer labs.
- Students must sign the Acceptable Use agreement from the technology department to use county technology.
- Students will be held liable for any inappropriate use of all school technology.

## Early Dismissals

- Students must sign out with parent note or be accompanied by a parent who signs them out.
- Any student who leaves school without permission after arriving on school property will be subject to disciplinary action as defined in section 46 of the SHS Discipline Matrix. No exceptions are made for students who leave campus without following the appropriate procedures. Driving privileges may also be revoked. Parent conferences will be required for students who skip.

## **Early Graduation**

Students wishing to graduate early must be approved by Central Office, and must confer with their school counselor.

## **Emergency Drills**

Emergency drills are an important process that requires all our attention. Everyone is expected to follow all emergency guidelines when practicing emergency drills.

## **Final Exam Exemptions**

As of the 2020-2021 school year, no students are exempt from final exams or midterm exams.

## **Grade Classification**

Student's eligibility for various student privileges is based on the number of years spent in high school. For purposes of staying on track for the four-year graduation plan, students are encouraged to earn the cumulative minimum credits per school year. Students will be classified according to the number of credits earned:

- Freshman: less than 6 credits
- Sophomore: 6, but less than 12 credits
- Junior: 12, but less than 20 credits
- Senior: 20 or more credits

Students will not be reclassified until the end of an academic year. However, during the fourth academic year, an underclassman may be reclassified to senior standing.

## **Grading Scale**

- Academic grades shall reflect the student's progress toward the attainment of the knowledge and skills in the subject area. Academic grades shall not be reduced as punishment for inappropriate behavior, except in such incidents where the student's grade is affected by cheating or failure to complete work. Attendance shall not be a factor in determining academic grades, except that credit for assignments may be denied or the value reduced for unexcused absences.
- In grades 7-12, academic grades shall be expressed by the following:
  - Α=93-100%
  - B=85-92%
  - C=75-84%
  - D=70-74%
  - F=Below 70%
- Grades may include a plus or minus except that no plus or minus shall be added to the final grade in any course.
- The grade of a student who has made satisfactory progress but has failed to complete assigned work may be recorded as incomplete (I). If the work is

not completed within the time designated by the teacher, the grade for that work will then become an "F".

- Grades given at the end of each nine-week period will be determined from daily work, homework, written assignments and tests. The teacher will weigh the value of grades given for various assignments and tests within the applicable period in computing the grade. This procedure will enable the teacher to allow for individual student differences in the grading process.

## Graduation Requirements

- To meet the requirements for graduation, a student shall have attained an approved attendance, conduct and subject matter record which covers a planned program of education, and such record shall be kept on file in the high school as documented by the student cumulative record.
- The program of studies shall include areas and content in these areas within State Board of Education. Regulations and shall be flexible enough to facilitate progress from one stage of development to another, thus providing for more effective student adjustment.
- The pattern of courses which shall be required of all students in grades nine (9) through twelve (12) shall be in accordance with the Rules and Regulations of the State Board of Education and the Board of Education.
- Before graduation, every student shall [1] achieve the specified 22 units of credit; [2] take the required end of course exams; have satisfactory records of attendance and conduct, and complete an 11 examination in the 11th grade (ACT)

SUBJECT	REQUIREMENTS
English Language Arts	4 Credits - English 9,10,11,12
Mathematics	4 Credits - Must include Algebra I, II, Geometry, and higher-level course
Science	3 Credits - Physical Science, Biology, Chemistry or Physics
Social Studies	3 Credits - World History or AP Human Geography, American History, .5 credit of Government and Civics and .5 credit of Economics
Physical Education	1.5 Credits
Fine Arts	1 Credit - Art, Theater, Music, Band
Foreign Language	2 Credits
Personal Finance	.5 Credit
Electives Focus	3 Credits - Math and Science, Career and Technical Education, Fine Arts, Humanities
Electives	4 or more

## **Hallway Procedures**

No student is allowed in the hallways, lobby, gym restrooms, parking lot, or outside of the building without a hall pass. Any student found in these areas without a hall pass is subject to being placed in ISS.

## **Honors & State Distinction**

- Any student who completes all graduation requirements with a minimum grade point average of 3.5 shall graduate with “Honors”.
- Any student will be recognized as graduation with “Distinction” who completes all graduation requirements with a minimum grade point average of 3.0 and one of the following criteria.
  - \*Earn a nationally recognized industry certification
  - \*Participate in at least one of the Governor’s Schools
  - \*Participate in one of the state’s All State musical organizations
  - \*Be selected as a National Merit Finalist or Semi-Finalist
  - \*Attain a score of 31 or higher composite score on the ACT
  - \*Attain a score of 3 or higher on at least two advanced placement exams
  - Earn 12 or more semester hours of transcript postsecondary credit.
- Any student who scores at or above all the subject area readiness benchmarks on the ACT or equivalent score on the SAT shall graduate with “State Honor”. Students achieving such will be recognized at their individual commencement.

## **In-School Suspension**

ISS will be assigned to students who cut classes, disrupt the classroom, or disrupt the normal progression of the school day.

- If a student is suspended and/or placed at ASPIRE for a cumulative total of 10 days over the course of the school year, a referral will be made to the Disciplinary Hearing Authority (DHA), and administration may recommend that the student be placed in an alternative setting.
- If a student is checked out of school when he/she is serving ISS, he/she must complete the remainder of the ISS time on the day they return.
- Upon accumulating 10 days of ISS, a student will be placed at the ASPIRE program for one day. Further infractions will result in additional days at ASPIRE.

## **Late Arrivals**

Students reporting to school after 8:25 should report to the main office. These students will be issued an admittance slip to class. The student’s name, first block teacher, and time of arrival will be recorded.

## **Lunch Period Procedures**

- Students are to go to lunch at their designated time.
- Students are not permitted to leave school for lunch.

- All students must report to the cafeteria at their designated lunch time.
- No restrooms will be used during lunch or the transition to the classroom.

## **Medicines**

*(RCS Board Policy 6.405)*

No school official/teacher will routinely dispense medication to students except in unique situations in which a child's health is dependent upon medical aid. If under exceptional circumstances, a child is required to take oral medication during school hours and the parent cannot be present, only the school nurse will administer the medication in compliance with the following regulations.

All Medications must be:

- Stored in a locked box in a secure area;
- Brought to school by a parent or guardian in a properly labeled pharmacy container (prescription drugs), or unopened bottle (over the counter medications);
- Accompanied by written permission from the parent/guardian.
- All medications require a physician's order demonstrating the necessity for such medication and the need to administer such medication, at school, during school hours (8:25 am to 3:25 pm). Medications to be given at school do not include medications taken daily or twice daily as these medications can be administered at home. Medications taken three or more times each day will be considered.
- This does not include, as needed or PRN medications such as albuterol multi-dose inhalers or epi-pens which a student, with a physician's order, may carry on their person. Physician's order must be on file with the school nurse.
- Emergency Medication: Epi-pens and inhalers may be kept with the student. Students carrying epi-pens or inhalers must have a physician's order stating they can use the epi-pen/inhalers without supervision. This physician's order must be accompanied by written permission from the parent or guardian.

## **Morning Arrival**

- Door open at 7:50
- Car riders will enter the building through the back doors of the cafeteria and remain in the cafeteria or small theater until 8:10. At 8:10, breakfast on the go will be served, and students will report directly to their first block class where they must remain.
- Student drivers will enter the building through the main gym lobby and remain in the gym until 8:10. At 8:10, breakfast on the go will be served, and students will report directly to their first block class where they must remain.
- Bus riders will enter the building at the D-Hall Theater entrance and remain in the large auditorium until 8:10. At 8:10, breakfast on the go will be served, and students will report directly to their first block class where they must remain.

## **Motor Vehicle Regulations**

- Parking permits will be issued at the beginning of the year.
- The permit will cost \$10.00 and must be displayed as directed in the vehicle. Parking permits may be obtained anytime during the school year from Ms. Proctor. Students parking on campus without a permit will receive a \$20.00 ticket. Multiple violations will result in the vehicle being towed at the expense of the owner.
- Students may not be in the parking lot or use cars during the school day without permission from administration.
- Students must enter the building when they arrive at school and not remain in their cars.
- Students must not park in a designated faculty, staff, visitor or handicap space (unless prior approval given for handicap.)
- All individuals driving on school property must drive in a safe manner and observe the fifteen mile an hour speed limit. Violators may lose driving privileges on school property, and extreme cases may be cited by the Robertson County Juvenile Court.

## **Over the Counter (OTC) Medicines:**

- Must be brought to school in a NEW, UNOPENED container and LABELED with student's name and a physician's order or letter from the parent or guardian detailing the necessity that such medication is needed.
- OTC medications shall be administered according to the manufacturer's recommendations, unless accompanied by a physician's order demonstrating his order for a different dosage to be administered.
- Aspirin/aspirin containing products, herbals and vitamins will not be administered without a physician's orders.

## **Physician's Orders and Parental/Guardian Consent to Treat:**

- Springfield High School has a full-time Registered Nurse (RN) on duty. A copy of all required orders and consent forms may be obtained from the school clinic. In most cases School Health Services can assist in obtaining physicians orders. It is advisable that each parent or guardian, of a student who requires medications at school, first speak with the RN on duty to ensure such medications are both appropriate to be dispensed at school and to ensure the required order(s) and consent form(s) are obtained.
- Note: Medications will NOT be dispensed without a signed physician order and/or parental or guardian consent has been obtained. There will be no exceptions to this requirement. It is incumbent upon the parent or guardian to ensure that required physician orders and parent/guardian permission and required forms are completed in order for the timely administration of required medications(s) at school. In lieu of this, parent/guardian may come to school and provide their child medications(s) without restriction. However, if such medications (as with narcotics) impair the students normal function such that the school nurse or other medical professional determines

that the student is unsafe or may suffer physical harm the school reserves the right to obtain the level of medical intervention to include emergency medical assistance and/or treatment deemed appropriate under the circumstances. In all cases the parent/guardian will be notified, if possible, prior to any intervention.

## **Provisions for Textbooks**

- Each student will be furnished a textbook(s) for appropriate classes. Some textbooks are online only. At the end of the term, all books previously distributed to the student will be returned to the teacher
- If a book has been in any way unduly abused or lost, the student will be billed for the damage or loss of the book. Each student is asked to write his/her name and the issuing teacher's name in the book. Report cards will be held for missing or damaged textbooks.

## **Senior Class Rank**

- A four-point Quality Point System will be used for determining student grade point averages (GPAs) and for ranking students. Seniors who take at least eight (8) courses designated as Advanced, AP, and/or Dual Enrollment shall be ranked according to their cumulative grade point average above students who do not take at least 8 advanced level courses.
- An unofficial standing will be calculated at the end of the fall term of the senior year, followed by a final, official ranking at the end of the third nine weeks. Students must be enrolled full time at the home base school to be eligible for ranking among the top high school seniors. Credits earned prior to entering the 9<sup>th</sup> grade will not be included in the computation of GPA and class ranking.

## **Sportsmanship**

Good sportsmanship is expected of all Springfield High School students. Springfield High School encourages students to support our teams with enthusiasm and to be courteous to our opponents and their fans. Remember, they are our guests. The sportsmanship displayed by SHS has a great deal to do with the way others feel toward our school.

## **Student Activities**

Students are encouraged to join those clubs or organizations in which they can participate and still maintain an acceptable level of academic accomplishment. There are many benefits gained by the students while participating in a co-curricular activity. Students who participate in activity programs tend to have higher grade-point averages, better attendance records, and fewer discipline problems. In addition, students learn

self-discipline, build self-confidence and develop skills needed to be productive citizens in today's society. Studies have concluded that colleges and future employers select students who have participated in activities over non-participants because active students are more likely to accept the challenges and responsibilities needed to become successful in life.

## **Student Appearance**

A student is not appropriately dressed if he/she is a disturbing influence to the educational environment because of his/her mode of dress. Should a student be improperly dressed, an appropriate action will be taken. These are the concerns set forth by Robertson County Board of Education policy 6.310.

- No head covering, except for religious head coverings
- No bare midriff, revealing necklines, tube tops, tank tops, or see-through tops (unless there is a full tank top underneath that covers the stomach and **ALL** undergarments)
- Appropriate length of shorts and skirts: Shorts and skirts may not be shorter than the tips of the fingerprints when hands are held down to their thigh. **Leggings can be worn with a dress, skirt, or top that meets dress code consistency.**
- Loungewear/Sleepwear is not permitted.
- Sleeveless shirts must be at least the width of a dollar bill. No undergarments or body parts should be visible for both males or females.
- No sagging pants. (No undergarments or shorts should be exposed)
- No attire promoting alcohol, tobacco, drugs, weapons or sex.
- No dusters or trench coats.
- No clothing containing advertising for gangs, gang symbols, hate groups, illegal activities, or offensive language.
- No unnatural eye contacts.
- Shoes/sandals must be worn always.
- Outer clothing which resembles lounge wear, pajamas, or underwear is prohibited.
- No spikes, chains, or other items that cause a safety concern
- No sunglasses allowed to be worn in the building.
- Blankets cannot be used or carried around at school. This is a safety concern.
- Uniforms of cheerleaders and athletes may be worn on the day of a game or pep rally at the direction of the coach or sponsor.

## **Tardies**

Tardy is defined as the failure to be at a designated location at a specified time. This could include arriving to school late or leaving school early. Once a student has 4 tardies (excused or unexcused) in a 9 week period, consequences will be assigned. At 4 tardies, the only allowable excused tardies are those that have supporting documentation. A student who walks to any area of the school other than the one where their class is and ends up being tardy to class will be considered as being



intentionally tardy which is the same as skipping and will receive the same consequence as skipping. (No less than 1 day placement at ASPIRE)

### **Tardy to School (1st Block)**

If a student is tardy to school or his/her first block class, he/she should visit the front office for a note to be admitted to class.

### **Tardy to class (2<sup>nd</sup>, 3<sup>rd</sup>, or 4<sup>th</sup> Block)**

Each hallway will have one faculty member at the beginning of 2<sup>nd</sup>, 3<sup>rd</sup>, and 4<sup>th</sup> block assigned to write tardy slips for tardy students during the first ten minutes of class. If you report to class without a tardy slip, you will be directed to the faculty member assigned to your hallway during that block. If you report to class 10 minutes late or more, you will be allowed to come into class, but you will be written up for skipping class which will result in one day of ISS for the first offense and OSS for each offense thereafter. If you have to be late to class, it is your responsibility to let your teacher know why and the details. No exceptions will be made for students reporting to class late more than 10 minutes after class has begun.

### **Using the Library or Computer Labs**

- Library books may be checked out for a period of three weeks. A fine of 10 cents per day is charged for overdue books. The maximum fine is \$3.00. Some reference materials may be checked out with librarian permission for overnight use.
- Report cards will be held if students fail to return books to the library.
- Students taking material from the library without permission will be prohibited from checking further materials out.
- Food and drink are not permitted in the learning media center.
- A fine of \$1.00 will be charged for any damages to or removal of bar codes.
- You must sign Robertson County's Acceptable Use policy to use any school-owned technology—including the Internet—at Springfield High School. This policy will be signed electronically when student registration is complete. School computers are monitored and privacy regarding internet use should not be expected by users. Our technology department actively checks for inappropriate use of our school technology and internet.
- Individual students visiting the library are expected to bring a pass from their classroom teacher. This includes the lunch period. All students must sign-in at the circulation desk.

### **Use of the School Phone**

If students need to use the phone it must be an emergency. The student must have a note from the teacher to use a school phone.

### **Valedictorian/Salutatorian**

- To be ranked as valedictorian or salutatorian, a student must be enrolled in the high school at least four of the seven semesters preceding the final

semester and must be ranked among those students who have taken at least eight (8) courses designated as Advanced courses, AP, and/or Dual Enrollment. In the event that multiple students have the same GPA, students who have taken at least 5 officially recognized \*advanced courses will be ranked above students who have not taken advanced courses.

- If after considering advanced courses, the final scores of students highest composite ACT score (on file at the time of calculation) will be used to determine final ranking. In the event that multiple students are equal on all of these outlined criteria, multiple valedictorians will be recognized.
- \*Advanced course are those courses which have been designated as such by the Director of Schools/Designee and have a quantitative and qualitative difference from the regular course.

## **Visitors**

All visitors are required to report to the main office, sign in and get permission for their visit and acquire a visitor's pass that must be worn the entire time they are on campus.

## **Zero-Tolerance**

In-order to ensure a safe, secure learning environment free of drugs, violence, and dangerous weapons, any student who engages in the following offenses will not be tolerated and will be classified as Zero-Tolerance behavior:

1. Any student determined to have brought to school or to be in unauthorized possession on school property of a firearm, as defined by Federal Law 18 U.S.C. 921.
2. Any student committing battery upon any teacher, principal, administrator, school resource officer, or any other employee of the Robertson County Board of Education.
3. Any student unlawfully possessing any drug including any controlled substance as defined in TCA 39-17-403 through TCA 39-17-415, or legend drug as defined in TCA 53-10-101.

# Discipline Procedures

## Springfield High School Discipline Matrix 2021-2022

	<b>Aggravated Assault: (MANDATORY DHA)</b>	<b>Consequence Level</b>	<b>Consequence Description</b>
<b>1</b>	An assault (as defined below) accompanied by circumstances that make the situation severe, such as the use of a deadly weapon or dangerous instrument; causing serious physical injury to another; committing the assault knowing, or having reason to know, the victim is a peace officer or a school staff member engaging in a school-related activity.	<b>Minimum</b>	*Out of school suspension until discipline hearing is had with the Discipline Hearing Authority
		↓	*Out of school suspension until discipline hearing is had with the Discipline Hearing Authority
		<b>Maximum</b>	*Out of school suspension until discipline hearing is had with the Discipline Hearing Authority

	<b>Alcohol (Mandatory DHA)</b>	<b>Consequence Level</b>	<b>Consequence Description</b>
<b>2</b>	<p>(Use/Possession/Under the Influence)</p> <p>Use, possession, or being under the influence of alcohol on school property, at school sponsored events, and on school sponsored transportation.</p>	<b>Minimum</b>	*Placement at ASPIRE until discipline hearing is had with the Discipline Hearing Authority
	<p>(Distribution/Sale)</p> <p>Sale or Distribution of Alcohol is the attempt or act of offering, selling, trading, procuring or distributing (with or without compensation) alcohol as defined above on District property, at a District-sponsored event, or on District-provided transportation.</p>	↓	*Placement at ASPIRE until discipline hearing is had with the Discipline Hearing Authority
		<b>Maximum</b>	*Placement at ASPIRE until discipline hearing is had with the Discipline Hearing Authority

	<b>Arson (Mandatory DHA)</b>	<b>Consequence Level</b>	<b>Consequence Description</b>
<b>3</b>	Knowingly damaging a structure or property (either occupied or unoccupied) by causing a fire or explosion.	<b>Minimum</b>	*Out of school suspension until discipline hearing is had with the Discipline Hearing Authority
		↓	*Out of school suspension until discipline hearing is had with the Discipline Hearing Authority
		<b>Maximum</b>	*Out of school suspension until discipline hearing is had with the Discipline Hearing Authority

	<b>Assault (Mandatory DHA)</b>	<b>Consequence Level</b>	<b>Consequence Description</b>
<b>4</b>	(1) Intentionally, knowingly or recklessly causing any physical injury to another person;  (2) intentionally placing another person in reasonable	<b>Minimum</b>	*Placement at ASPIRE until discipline hearing is had with the Discipline Hearing Authority

	apprehension of imminent physical injury;	↓	*Placement at ASPIRE until discipline hearing is had with the Discipline Hearing Authority
	or  (3) knowingly touching another person with the intent to injure, insult or provoke such person.	<b>Maximum</b>	*Placement at ASPIRE until discipline hearing is had with the Discipline Hearing Authority

	<b>Bullying</b>	<b>Consequence Level</b>	<b>Consequence Description</b>
<b>5</b>	Repeated acts over time that involve a real or perceived imbalance of power, with the more powerful child or group attacking those who are less powerful. Bullying may be physical in form (i.e., pushing, hitting, kicking, spitting, stealing); verbal (i.e., making threats, taunting, teasing, name-calling); or psychological (i.e., social exclusion, spreading rumors, manipulating social relationships). Cyber-bullying includes bullying through the misuse of technology.	<b>Minimum</b>	*3 day Placement at ASPIRE for first offense
		↓	*5 day Placement at ASPIRE for second offense
		<b>Maximum</b>	*Placement at ASPIRE until discipline hearing is had with the Discipline Hearing Authority

	<b>Cheating or Plagiarism</b>	<b>Consequence Level</b>	<b>Consequence Description</b>
<b>6</b>	Includes the act of intentionally using information or property of another, or knowingly sharing academic information to gain an unfair advantage. To steal and pass off the ideas or words of another as one's own. This includes the unauthorized use of electronic devices.	<b>Minimum</b>	* Academic penalty dependant upon specific academic department policy. *1 Day ISS from SHS Admin
		↓	* Academic penalty dependent upon specific academic department policy. *1 Day Placement at ASPIRE from SHS Admin
		<b>Maximum</b>	*Academic penalty dependent upon specific academic department policy. *3 days Placement at ASPIRE from SHS Admin

	<b>Combustibles</b>	<b>Consequence Level</b>	<b>Consequence Description</b>
<b>7</b>	Includes objects that are readily capable of causing bodily harm or property damage, i.e. matches, lighters, firecrackers, gasoline, and lighter fluid.	<b>Minimum</b>	*Confiscation *1 day ISS
		↓	*Confiscation *1 day Placement at ASPIRE
		<b>Maximum</b>	*Confiscation *3 days Placement at ASPIRE

	<b>Dangerous Instruments (Mandatory DHA)</b>	<b>Consequence Level</b>	<b>Consequence Description</b>
<b>8</b>	Includes items that are used, attempted or threatened to be used, and/or is readily capable of causing death or physical injury to any person. Dangerous instruments include, but are not limited to, air soft guns, B.B. guns, knife with a blade length more than 4 inches, letter opener, mace, paintball gun, pellet gun, razor blade or box cutter, simulated knife, Taser/stun gun, or tear gas. Sale or Distribution of Dangerous Instruments is the attempt or act of offering, selling, trading, procuring or distributing (with or without compensation) dangerous instruments on	<b>Minimum</b>	*Confiscation *Out of school suspension until discipline hearing is had with the Discipline Hearing Authority
		↓	*Confiscation *Out of school suspension until discipline hearing is had with the Discipline Hearing Authority



	District property, at a school related or district-sponsored event such as athletic events (home or away), or on school-sponsored transportation.	<b>Maximum</b>	*Confiscation *Out of school suspension until discipline hearing is had with the Discipline Hearing Authority
--	---	----------------	--

	<b>Defiance/Disrespect</b>	<b>Consequence Level</b>	<b>Consequence Description</b>
<b>9</b>	Intentionally resisting or disregarding the authority of District personnel or treating District personnel or any others with contempt or rudeness. This includes, but is not limited to, swearing at OR about an adult in their presence, the failure to respond to a reasonable request/follow directions, being disobedient or the refusal to identify self when requested to do so.	<b>Minimum</b>	*1 day Placement at ASPIRE
		↓	*1-3 Placement at ASPIRE
		<b>Maximum</b>	*3-5 days Placement at ASPIRE

	<b>Disorderly Conduct</b>	<b>Consequence Level</b>	<b>Consequence Description</b>
<b>10</b>	<p>Any act which substantially disrupts the orderly conduct of a school function, or behavior which substantially disrupts the orderly learning environment. Example 1: An administrator is called to a classroom because a teacher cannot continue teaching due to the behavior of a student. Example 2: Arguments with other students that border on becoming physical and require adult intervention.</p> <p>*Disorderly Conduct with Contact (Possible DHA)</p> <p>Aggressive physical behavior towards others, which substantially disrupts the orderly learning environment.</p>	<b>Minimum</b>	*2 days Placement at ASPIRE (First Offense)
		↓	*3 days Placement at ASPIRE (Second Offense)
		<b>Maximum</b>	*5 days Placement at ASPIRE or DHA if student has accumulated 10 days or more Aspire Placements on a third offense

	<b>Disruption</b>	<b>Consequence Level</b>	<b>Consequence Description</b>
<b>11</b>	<p>Creating disturbances in class, on campus or at school-sponsored events. Continual or repeated disruptions may</p>	<b>Minimum</b>	*1 day ISS
		↓	*1-3 days Placement at ASPIRE

	warrant more severe consequences.	<b>Maximum</b>	*3-5 days Placement at ASPIRE
--	-----------------------------------	----------------	----------------------------------

	<b>Dress Code</b>	<b>Consequence Level</b>	<b>Consequence Description</b>
<b>12</b>	The act of non-compliance with the established student dress code guidelines. Includes dress code violations as stated in Robertson County Schools handbook.	<b>Minimum</b>	*Change clothes/Correct violation OR serve 1 day ISS
		↓	*Change clothes/Correct violation OR serve 2 days ISS
		<b>Maximum</b>	*Change clothes/Correct violation OR serve 2 days at ASPIRE Program

	<b>Drugs (Mandatory DHA)</b>	<b>Consequence Level</b>	<b>Consequence Description</b>
<b>13</b>	<p>Use/Possession/Under the Influence</p> <p>Includes the act of using, possessing and/or being under the influence of chemical substances, narcotics, prescription or non-prescription medications, inhalants, controlled substances or substances that students represent to be chemical substances, narcotics or controlled substances. Over-the-counter, non-prescription pharmaceuticals fall into this definition, unless the student has complied with the District's policy for such medication. The term "drugs" includes anything that looks like drugs or which is presented as drugs. Drug residue is also considered a "drug."</p>	<b>Minimum</b>	*Placement at ASPIRE until discipline hearing is had with the Discipline Hearing Authority
		↓	*Placement at ASPIRE until discipline hearing is had with the Discipline Hearing Authority
	<p>Distribution/Sale</p> <p>Distribution or Sale of Drugs as defined above is the attempt or act of offering, selling, trading, procuring or distributing (with or without compensation) drugs on District property, at a District-sponsored event, or on sponsored transportation.</p>	<b>Maximum</b>	*Placement at ASPIRE until discipline hearing is had with the Discipline Hearing Authority

	<b>Drug/Tobacco Paraphernalia</b>	<b>Consequence Level</b>	<b>Consequence Description</b>
<b>14</b>	Includes any apparatus or equipment used, including anything that looks like apparatus or equipment used or that can be used, intended for use or designed for use in the act of smoking, injecting, ingesting, inhaling or otherwise introducing into the human body a drug on District property, at a District-sponsored event or on District sponsored transportation. Examples include, but are not limited to: rolling papers, pipes, and electronic cigarette devices/vapes or products. Also includes any items which are used to store, package or maintain any drug or tobacco substances. If any such paraphernalia includes drug or tobacco residue, the residue will be considered a drug or tobacco pursuant to the definitions for each. Sale or Distribution of Paraphernalia is the attempt or act of offering, selling, trading, procuring or distributing (with or without compensation) on District	<b>Minimum</b>	*Confiscation *1 day Placement at ASPIRE
		↓	*Confiscation *3 days Placement at ASPIRE

	<p>property, at a District-sponsored event or on transportation.</p> <p>(Distribution or Sale)          Distribution or Sale as described above of Paraphernalia is the attempt or act of offering, selling, trading, procuring or distributing (with or without compensation) on District property, at a District-sponsored event or on District sponsored transportation.</p>	<b>Maximum</b>	<p>*Confiscation          *5 days Placement at ASPIRE</p>
--	---	----------------	---

	<b>Electronic Devices</b>	<b>Consequence Level</b>	<b>Consequence Description</b>
<b>15</b>	<p>Includes cell phones, headphones, AirPods, hand-held devices, media players or other electronic items. These items must be in the off position and not be displayed for use during the school day from bell to bell, unless otherwise directed by a staff member for instructional purposes or for use as an educational resource. Electronic Devices may not interfere with the learning, safety or well-being of others. Springfield High School is not responsible for the loss,</p>	<b>Minimum</b>	<p>*Confiscation          *Wait 3 school days or pay \$10 fine to have phone returned at the end of the day on the day that the phone is confiscated.</p>
		↓	<p>*Confiscation          *Wait 5 school days or pay \$20 fine to have phone returned at the end of the day on the day</p>

	damage and/or theft of any of these types of devices.		that the phone is confiscated.
		<b>Maximum</b>	*Confiscation *Wait 10 school days or pay \$30 fine to have phone returned at the end of the day on the day that the phone is confiscated.

	<b>Endangerment</b>	<b>Consequence Level</b>	<b>Consequence Description</b>
<b>16</b>	Recklessly or intentionally creating, engaging in, encouraging or failing to report any potential unsafe, dangerous or hazardous situation. Endangerment can include a risk to the health, safety and welfare of students and staff. Endangerment can include risk of injury, harm and death. Consequences depend on the potential severity of the endangerment. Consequences depend on the direct or indirect involvement of the endangerment, including acting as an accessory.	<b>Minimum</b>	*1 day Placement at ASPIRE
		↓	*Up to 5 days Placement at ASPIRE
		<b>Maximum</b>	*Placement at ASPIRE until discipline hearing is had with the Discipline Hearing Authority

	<b>Extortion</b>	<b>Consequence Level</b>	<b>Consequence Description</b>
<b>17</b>	The act of knowingly obtaining or seeking to obtain property or services or causing or seeking to cause another to act in a manner, by means of a threat to do any of the following: (1) cause physical injury; (2) cause damage to property; (3) engage in illegal conduct; or (4) make false accusations.	<b>Minimum</b>	3 days Placement at ASPIRE
		↓	5 days Placement at ASPIRE
		<b>Maximum</b>	*Placement at ASPIRE until discipline hearing is had with the Discipline Hearing Authority

	<b>Fighting</b>	<b>Consequence Level</b>	<b>Consequence Description</b>
<b>18</b>	Mutual participation in an incident involving physical violence.	<b>Minimum</b>	*5 days Placement at ASPIRE
		↓	*Placement at ASPIRE until discipline hearing is had with the Discipline Hearing Authority



		<b>Maximum</b>	*Placement at ASPIRE until discipline hearing is had with the Discipline Hearing Authority
--	--	----------------	--

	<b>Fire Alarm Misuse</b>	<b>Consequence Level</b>	<b>Consequence Description</b>
<b>19</b>	Intentionally ringing fire alarm when there is no fire.	<b>Minimum</b>	3 days Placement at ASPIRE
		↓	5 days Placement at ASPIRE
		<b>Maximum</b>	*Placement at ASPIRE until discipline hearing is had with the Discipline Hearing Authority

	<b>Firearm (Mandatory DHA)</b>	<b>Consequence Level</b>	<b>Consequence Description</b>
<b>20</b>	Any weapon that is designed to (or may be readily converted to) expel a projectile by an explosive, or by the action of an explosive. This includes any handguns, pistol, revolver, rifle, shot gun. Any destructive device, which includes: any	<b>Minimum</b>	*Out of school suspension until discipline hearing is had with the Discipline Hearing Authority

	explosive, incendiary, or poison gas, bombs, grenades, mines, rockets, missiles, pipe bombs, firearms or similar devices designed to explode and capable of causing bodily harm or property damage. Sale or Distribution of Firearms is the attempt or act of offering, selling, trading, procuring or distributing (with or without compensation) on District property, at a District-sponsored event, or on District-provided transportation.	↓	*Out of school suspension until discipline hearing is had with the Discipline Hearing Authority
		<b>Maximum</b>	*Out of school suspension until discipline hearing is had with the Discipline Hearing Authority

	<b>Forgery/Falsification</b>	<b>Consequence Level</b>	<b>Consequence Description</b>
<b>21</b>	The act of falsely or fraudulently marking or altering a document or a verbal, written or electronic communication, or any verbal or written communication that is intentionally false or fraudulent (i.e., dishonesty or lying, filing a false report).	<b>Minimum</b>	*1 day Placement at ASPIRE
		↓	*3 days Placement at ASPIRE
		<b>Maximum</b>	*5 days Placement at ASPIRE

	<b>Gambling</b>	<b>Consequence Level</b>	<b>Consequence Description</b>
<b>22</b>	Is to risk money or anything of value on the outcome of anything of chance	<b>Minimum</b>	*1 day Placement at ASPIRE

		↓	*3 days Placement at ASPIRE
		<b>Maximum</b>	*5 days Placement at ASPIRE

	<b>Gang Activity/Negative Group Affiliation</b>	<b>Consequence Level</b>	<b>Consequence Description</b>
<b>23</b>	An activity or affiliation of an ongoing loosely organized association of two or more persons, whether formal or informal, that has a common name, signs, symbols or colors, and whose members engage, either individually or collectively, in negative group activity.	<b>Minimum</b>	*3 days Placement at ASPIRE
		↓	*5 days Placement at ASPIRE
		<b>Maximum</b>	*Placement at ASPIRE until discipline hearing is had with the Discipline Hearing Authority

	<b>Harassment</b>	<b>Consequence Level</b>	<b>Consequence Description</b>
<b>24</b>	The intentional behavior by a student or group of students that is disturbing or threatening to another individual or group of individuals. Intentional behaviors that characterize harassment include, but are	<b>Minimum</b>	*1 day Placement at ASPIRE
		↓	*3 days Placement at ASPIRE

	not limited to stalking, hazing, social exclusion, name calling, unwanted physical contact and unwelcome verbal or written comments, photographs graphics, and social media posts.	<b>Maximum</b>	*5 days Placement at ASPIRE
--	--	----------------	--------------------------------

	<b>Hate/Bias Related Incidents</b>	<b>Consequence Level</b>	<b>Consequence Description</b>
25	Any written, oral, physical or electronic communication that one could reasonably conclude was motivated, in whole or in part, by the perpetrator’s bias or attitude against an individual victim or group based on perceived or actual personal characteristics. Examples of bias/hate related incidents include age, ancestry or ethnicity, disability, economic status, gender, height or weight, immigration or citizenship status, marital status, race, religion or religious practices, or sexual orientation.	<b>Minimum</b>	*3 days Placement at ASPIRE
		↓	*5 days Placement at ASPIRE
		<b>Maximum</b>	*Placement at ASPIRE until discipline hearing is had with the Discipline Hearing Authority

	<b>Hazing</b>	<b>Consequence Level</b>	<b>Consequence Description</b>
26	Any intentional, knowing or reckless act committed by a student, whether individually	<b>Minimum</b>	*3 days Placement at ASPIRE

	or in concert with other persons, against another student, committed in connection with an initiation into an affiliation or membership in any organization, that is affiliated with an educational institution or when the act contributes to a substantial risk of potential physical injury, mental harm or degradation, or causes physical injury, mental harm or personal degradation.		
		↓	*5 days Placement at ASPIRE
		<b>Maximum</b>	*Placement at ASPIRE until discipline hearing is had with the Discipline Hearing Authority

	<b>Horseplay/Roughhousing/Recklessness</b>	<b>Consequence Level</b>	<b>Consequence Description</b>
<b>27</b>	Includes rough, boisterous play or behavior.	<b>Minimum</b>	* 1 day ISS
		↓	*2 days ISS
		<b>Maximum</b>	*1-3 days Placement at ASPIRE

	<b>Indecent Exposure or Public Sexual Indecency (Mandatory DHA)</b>	<b>Consequence Level</b>	<b>Consequence Description</b>
<b>28</b>	Includes, but is not limited to, exposing private areas, consensual participation in any sexual act involving physical contact, touching private areas, depantsing (pulling pants down or off), pulling at another's underclothing.	<b>Minimum</b>	*Placement at ASPIRE until discipline hearing is had with the Discipline Hearing Authority
		↓	*Placement at ASPIRE until discipline hearing is had with the Discipline Hearing Authority
		<b>Maximum</b>	*Placement at ASPIRE until discipline hearing is had with the Discipline Hearing Authority

	<b>Instigation</b>	<b>Consequence Level</b>	<b>Consequence Description</b>
<b>29</b>	Includes provoking, antagonizing or failing to report a fight or other dangerous, inappropriate situations. Spreading rumors, harmful gossip,	<b>Minimum</b>	*3 days Placement at ASPIRE
		↓	*5 days Placement at ASPIRE

	recording/videotaping, social media posting and use of language or gestures that may incite another person or other people to fight are also considered forms of instigation.	<b>Maximum</b>	*Placement at ASPIRE until discipline hearing is had with the Discipline Hearing Authority
--	---	----------------	--

	<b>Physical Aggression</b>	<b>Consequence Level</b>	<b>Consequence Description</b>
<b>30</b>	The act of tussles, minor confrontations, pushing, shoving, slapping, hitting, kicking or other physical provocation.	<b>Minimum</b>	*3 days Placement at ASPIRE
		↓	*5 days Placement at ASPIRE
		<b>Maximum</b>	*Placement at ASPIRE until discipline hearing is had with the Discipline Hearing Authority

	<b>Public Display of Affection</b>	<b>Consequence Level</b>	<b>Consequence Description</b>
<b>31</b>	The act of kissing, hugging, fondling or touching in public that is beyond casual contact and which creates, or has the potential to create, a disturbance.	<b>Minimum</b>	*Warning
		↓	*1 day ISS
		<b>Maximum</b>	*1 day Placement at ASPIRE

--	--	--	--

	<b>Robbery (Mandatory DHA)</b>	<b>Consequence Level</b>	<b>Consequence Description</b>
<b>32</b>	The taking, or attempting to take, any property of another from his person or immediate presence and against his will. Such person threatens or uses force against any person with intent to either coerce surrender of property, or to prevent resistance to such person taking or retaining property.	<b>Minimum</b>	*Placement at ASPIRE until discipline hearing is had with the Discipline Hearing Authority
		↓	*Placement at ASPIRE until discipline hearing is had with the Discipline Hearing Authority
		<b>Maximum</b>	*Placement at ASPIRE until discipline hearing is had with the Discipline Hearing Authority

	<b>Sale/Distribution of Personal Property</b>	<b>Consequence Level</b>	<b>Consequence Description</b>
<b>33</b>	The attempt or act of offering, selling, trading, procuring or distributing (with or without compensation) personal property, goods or services on	<b>Minimum</b>	*Confiscation *1 day ISS
		↓	*Confiscation *2 days ISS



	District property, at a school or District-sponsored event or on District- provided transportation.	<b>Maximum</b>	*Confiscation *1 day Placement at ASPIRE
--	---	----------------	--

	<b>Sexual Harassment</b>	<b>Consequence Level</b>	<b>Consequence Description</b>
<b>34</b>	The unwelcome conduct of a sexual nature that denies or limits a student’s ability to participate in or to receive benefits, services, or opportunities in the school’s program. It can include unwelcome sexual advances, requests for sexual favors, and other verbal, nonverbal, or physical conduct of a sexual nature.	<b>Minimum</b>	*3 days Placement at ASPIRE
		↓	*5 days Placement at ASPIRE
		<b>Maximum</b>	*Placement at ASPIRE until discipline hearing is had with the Discipline Hearing Authority

	<b>Tardy</b>	<b>Consequence Level</b>	<b>Consequence Description</b>
<b>35</b>	The failure to be at a designated location at a specified time. This could include arriving to school late or leaving school early. Once a student has 4 tardies (excused or unexcused) in a 9-week period, consequences will be assigned. At 4 tardies, the only	<b>Minimum</b>	*Lunch detention assigned for 4-10 tardies in one 9 weeks
		↓	*1-day ISS for each tardy to school or class for 11-15 tardies

	allowable excused tardies are those that have supporting documentation. A student who walks to any area of the school other than the one where their class is and ends up being tardy to class will be considered as being intentionally tardy which is the same as skipping and will receive the same consequence as skipping. (No less than 1 day OSS)	<b>Maximum</b>	*1 day placement at ASPIRE for each tardy after 15 in one nine weeks period
--	--	----------------	---

	<b>Technology Misuse</b>	<b>Consequence Level</b>	<b>Consequence Description</b>
<b>36</b>	The failure to use hardware, software, electronic devices, web pages and networks for the intended educational use or in a manner that causes disruption at a campus or any District facility, including proxy use. See Acceptable Use Policy (AUP) User Agreement.	<b>Minimum</b>	*Loss of technology privileges *Restitution *1 day ISS
		↓	*Loss of technology privileges *Restitution *2 days ISS
		<b>Maximum</b>	*Loss of technology privileges *Restitution *1 day Placement at ASPIRE

	<b>Technology/Computer Tampering</b>	<b>Consequence Level</b>	<b>Consequence Description</b>
<b>37</b>	Computer Tampering includes, altering, damaging, deleting or destroying a computer, computer hardware or software; introducing a computer contaminant into any computer, or network; causing the disruption of a computer or network. See Acceptable Use Policy (AUP) User Agreement.	<b>Minimum</b>	*Loss of technology privileges *Restitution *1 day Placement at ASPIRE
		↓	*Loss of technology privileges *Restitution *2 days Placement at ASPIRE
		<b>Maximum</b>	*Loss of technology privileges *Restitution *3 days Placement at ASPIRE

	<b>Theft</b>	<b>Consequence Level</b>	<b>Consequence Description</b>
<b>38</b>	The taking of property that belongs to another without personal confrontation, threat, violence or bodily harm. Theft does not include confiscation by school authorities of property not permitted at the school. NOTE: The District is NOT responsible for the loss, theft or damage of ANY personal items brought to	<b>Minimum</b>	*Restitution *1-3 days Placement at ASPIRE
		↓	*Restitution *3-5 days Placement at ASPIRE

	<p>school, including but not limited to, musical instruments, radios, headphones, cell phones, iPods, iPads, (any and all electronic devices), bicycles, etc.</p>	<p><b>Maximum</b></p>	<p>*Placement at ASPIRE until discipline hearing is had with the Discipline Hearing Authority</p>
--	---	-----------------------	---

	<p><b>Threat/Bomb (Mandatory DHA)</b></p>	<p><b>Consequence Level</b></p>	<p><b>Consequence Description</b></p>
<p><b>39</b></p>	<p>Threatening to cause harm using a bomb, dynamite, explosive, or arson-causing device.</p>	<p><b>Minimum</b></p>	<p>*Placement at ASPIRE until discipline hearing is had with the Discipline Hearing Authority</p>
		<p>↓</p>	<p>*Placement at ASPIRE until discipline hearing is had with the Discipline Hearing Authority</p>
		<p><b>Maximum</b></p>	<p>*Placement at ASPIRE until discipline hearing is had with the Discipline Hearing Authority</p>

	<b>Threat/Chemical or Biological (Mandatory DHA)</b>	<b>Consequence Level</b>	<b>Consequence Description</b>
<b>40</b>	Threatening to cause harm using dangerous chemicals or biological agents.	<b>Minimum</b>	*Placement at ASPIRE until discipline hearing is had with the Discipline Hearing Authority
		↓	*Placement at ASPIRE until discipline hearing is had with the Discipline Hearing Authority
		<b>Maximum</b>	*Placement at ASPIRE until discipline hearing is had with the Discipline Hearing Authority

	<b>Threat, Other</b>	<b>Consequence Level</b>	<b>Consequence Description</b>
<b>41</b>	The incident cannot be coded in one of the above categories but did involve a school threat. This includes Death Threats (Mandatory DHA).	<b>Minimum</b>	*1 day placement at ASPIRE
		↓	*3 days placement at ASPIRE
		<b>Maximum</b>	*Placement at ASPIRE until discipline hearing is had with the Discipline

			Hearing Authority
--	--	--	-------------------

	Threatening/Intimidating Behavior	Consequence Level	Consequence Description
42	When a person indicates by word or conduct, the intent to cause physical injury or serious damage to a person or their property. Repeated acts of threatening, intimidating behavior shall be considered Bullying.	Minimum	*1 day placement at ASPIRE
		↓	*3 days placement at ASPIRE
		Maximum	*Placement at ASPIRE until discipline hearing is had with the Discipline Hearing Authority

	Tobacco	Consequence Level	Consequence Description
43	Includes use, possession of tobacco products of any kind smoke or smokeless on District property, at a District-sponsored event, or on District-sponsored transportation. (i.e., cigarettes, cigars, dip, chew, snuff, twist, etc.)  NOTE: Possession by any person of tobacco products on K-12 public, charter or private school grounds, buildings, parking lots, playing fields and vehicles, and at off-campus	Minimum	*1 day placement at ASPIRE
		↓	*3 days placement at ASPIRE

	school-sponsored events, is a criminal offense in the state of Tennessee.	<b>Maximum</b>	*5 days placement at ASPIRE
--	---	----------------	-----------------------------

	<b>Tobacco Sale or Distribution</b>	<b>Consequence Level</b>	<b>Consequence Description</b>
<b>44</b>	Includes tobacco products as defined above. Distribution or Sale of Tobacco is the attempt or act of offering, selling, trading, procuring or distributing (with or without compensation) on District property, at a District-sponsored event, or on District-sponsored transportation.	<b>Minimum</b>	*1 day placement at ASPIRE
		↓	*3 days placement at ASPIRE
		<b>Maximum</b>	*5 days placement at ASPIRE

	<b>Trespass or Loiter</b>	<b>Consequence Level</b>	<b>Consequence Description</b>
<b>45</b>	When a person enters upon, or in, school property without legal justification or without the implied or actual permission of the administration, or when a person is intentionally present on school grounds, after a reasonable request to leave, does not have any specific reason for being there, or does not have written permission to	<b>Minimum</b>	*1 day placement at ASPIRE
		↓	*3 days placement at ASPIRE

	be there from anyone authorized to grant permission.	<b>Maximum</b>	*5 days placement at ASPIRE
--	--	----------------	-----------------------------

	<b>Unauthorized Absence/Truancy/Leaving Campus without Authorization (Skipping)</b>	<b>Consequence Level</b>	<b>Consequence Description</b>
<b>46</b>	An unexcused absence for at least 10 minutes after a class period has begun during the school day or when a student is absent from school during the hours school is in session, unless excused. Also known as ditching or skipping class/school. Springfield High School is a closed campus which means that students must remain on the school campus, attend all assigned classes and lunch periods unless otherwise authorized by school administration	<b>Minimum</b>	*1 day placement at ASPIRE
		↓	*3 days placement at ASPIRE
		<b>Maximum</b>	*5 days placement at ASPIRE

	<b>Vandalism/Destruction of Property-Under \$100</b>	<b>Consequence Level</b>	<b>Consequence Description</b>
<b>47</b>	The willful act of defacing or destroying any building, fixture, vegetation or property (personal or school) either	<b>Minimum</b>	*1 day placement at ASPIRE *Restitution



	intentionally or unintentionally.	↓	*3 days placement at ASPIRE *Restitution
		<b>Maximum</b>	*5 days placement at ASPIRE *Restitution

	<b>Vehicle Violations</b>	<b>Consequence Level</b>	<b>Consequence Description</b>
<b>48</b>	Includes improper driving, operation, or parking of a vehicle on school District property without permission, parking in prohibited areas, and/or improper driving to or from campus.	<b>Minimum</b>	*Conference *Notify Parent
		↓	*Temporary loss of driving privileges
		<b>Maximum</b>	*Revocation of driving privileges

	<b>Verbal Abuse/Profanity/Obscenity</b>	<b>Consequence Level</b>	<b>Consequence Description</b>
<b>49</b>	The use of profanity, swearing or any derogatory language written or stated publicly.	<b>Minimum</b>	*1 day ISS
		↓	*1-3 days ISS
		<b>Maximum</b>	*1-3 days placement at ASPIRE

	<b>Verbal Abuse/Profanity/Obscenity to an Adult</b>	<b>Consequence Level</b>	<b>Consequence Description</b>
<b>50</b>	The use of profanity, swearing or any derogatory language written or stated publicly to an adult.	<b>Minimum</b>	*1 day placement at ASPIRE

		↓	*3 days placement at ASPIRE
		<b>Maximum</b>	*3-5 days placement at ASPIRE

	<b>Weapon – Simulated (Mandatory DHA)</b>	<b>Consequence Level</b>	<b>Consequence Description</b>
<b>51</b>	Any simulated firearm made of plastic, wood, metal or any other material which is a replica, facsimile, or toy version of a firearm or any object such as a stick or finger concealed under clothing and is being portrayed as a firearm.	<b>Minimum</b>	*Placement at ASPIRE until discipline hearing is had with the Discipline Hearing Authority
		↓	*Placement at ASPIRE until discipline hearing is had with the Discipline Hearing Authority
		<b>Maximum</b>	*Placement at ASPIRE until discipline hearing is had with the Discipline Hearing Authority

	<b>Weapons - Other (Use/Possession/Distribution/ Sale) (Mandatory DHA)</b>	<b>Consequence Level</b>	<b>Consequence Description</b>
<b>52</b>	Includes (but not limited to) a dagger, dirk, stiletto, knife with a blade at least 4 inches in length, pocket knife opened by a mechanical device, iron bar, brass knuckles, chains, billy clubs, Chinese stars, nunchakus or any incendiary devices. Distribution/Sale is the attempt or act of offering, selling, trading, procuring or distributing (with or without compensation) a weapon on District property, at a school or District-sponsored event or on District-provided transportation.	<b>Minimum</b>	*Placement at ASPIRE until discipline hearing is had with the Discipline Hearing Authority
		↓	*Placement at ASPIRE until discipline hearing is had with the Discipline Hearing Authority
		<b>Maximum</b>	*Placement at ASPIRE until discipline hearing is had with the Discipline Hearing Authority

# **ROBERTSON COUNTY SCHOOLS' BULLYING AND HARASSMENT PROCEDURE (RCS Board Policy 6.304)**

The Robertson County Schools' Bullying and Harassment Procedure will be disseminated annually to all school staff, students, and parents via the Robertson County Handbook and website. This policy is in effect while students are on school property, at any school sponsored activity, on school provided equipment or transportation, or at any official school bus stop. If the act takes place off school property or outside of a school sponsored activity, this policy is in effect if the conduct is directed specifically at a student or students and has the effect of creating a hostile educational environment or otherwise creating a substantial disruption to the education environment or learning process. These acts may also take place through electronic means. ("Cyber-bullying" is bullying undertaken through the use of electronic devices. Electronic devices include, but are not limited to telephones, cellular phones or other wireless telecommunication devices, text messaging, emails, social networking sites, instant messaging, videos, websites, or fake profiles.)

"Bullying" is conduct that meets one or more of the following criteria:

1. Is an act directed at one or more students that is intended to harm or embarrass
2. Is repeated over time and
3. Involves an imbalance of physical, emotional or social power

"Bullying" can be conducted verbally and in writing (teasing, name calling, taunting, threatening to cause harm) socially/relationally (hurting someone's reputation or relationship), or physically (hurting someone or their possessions).

Other acts of violent behavior may include:

"Hazing" which involves any intentional or reckless act, on or off any property owned by Robertson County Schools, by one student acting alone or with others that is directed against any other student, that endangers the mental or physical health or safety of that student or that induces or coerces a student to endanger that student's mental or physical health or safety. ("Hazing" does not include customary athletic events or similar contests or competitions and is limited to those actions taken and situations created in connection with initiation into of affiliations with any organization.)

## **Reporting and Investigations**

The policy requires the principal and /or principal's designee, at each school to be responsible for investigating and resolving complaints alleging violation of this policy. They are responsible for determining whether an alleged act constitutes a violation of this policy. They shall conduct a prompt, thorough, and complete investigation of each alleged incident. Once determined as the result of an investigation that the policy has been violated, within the parameters of the Federal Family Educational Rights and Privacy Act (FERPA) at 20 U.S.C.§ 1232g, a written report on the investigation will be delivered to the parents of the complainant and accused student(s) and to the Director of Schools. Documentation of all alleged violations of the bullying policy will be kept for historic reference.

All school employees are required to report alleged violations of this policy to the principal and/or principal's designee. All other members of the school community including students, parents, volunteers, and visitors, are encouraged to report any act

that may be a violation of this policy. Reports may be made anonymously; however, such complaints may affect the school's ability to issue formal disciplinary action.

## **Preventions and Intervention Response**

Consequences and appropriate remedial actions (correct the problem behavior, prevent other occurrences of the behavior; and protect the victim of the act) for anyone who commits one or more acts of harassment, bullying, or other acts of violent behavior may range from positive incentives up to and including suspension or expulsion, as set forth in the Robertson County Board of Education's approved code of conduct.

School administrators shall consider the nature and circumstances of the incident, the age and maturity of the student, the degree of harm, previous incidences or pattern of behavior, or any other factors, as appropriate to properly respond to each situation. Consequences for a student who commits an act of harassment, bullying or other act of violent behavior shall be unique to the individual incident and will vary in method and severity according to the nature of the behavior, the developmental age of the student, and the student's history of problem behaviors and performance, and must be consistent with the Board of Education's approved code of student conduct.

## **Reprisal, Retaliation, and False Accusations**

The Robertson County Board of Education prohibits reprisal or retaliation against any person who reports or assists in any investigation of an act alleged in this policy. It prohibits any person from falsely accusing another of having committed an act of harassment or bullying as means of reprisal or retaliation. The consequences of appropriate remedial action for a person who engages in reprisal or retaliation shall be determined by the administrator after consideration of the nature, severity, and circumstances of the act.

District Contact, Teresa Leavitt, Supervisor of Student Services

Phone: 384-5588 Email: [teresa.leavitt@rcstn.net](mailto:teresa.leavitt@rcstn.net)

## **Springfield High School Fight Song**

*Oh, fight Springfield High School,  
Fight, fight, fight!  
Fight for your High School tonight!  
Here's to remind you  
We're all behind you  
So, fight Springfield High School fight!  
Cheer every student,  
Cheer, cheer, cheer!  
Cheer for your High School tonight!  
They say we're gonna win  
'Cuz we got that pep and vim,  
So, fight Springfield High School fight!*

~~~~~

## **Springfield High School Alma Mater**

*On our City's eastern border  
Reared against the sky  
Proudly stands our Alma Mater  
As the years go by.  
Forward ever be our watchword  
Conquer and prevail.  
Hail to thee our Alma Mater  
Springfield High, All hail.*